

SELF CLINCH NUTS

Self clinch studs available in hardened steel zinc plated and Stainless Steel A2. Self clinch nuts persuade material from the mating sheet to flow around the self clinch groove and notches. They are designed to ensure the sheet is completely flush on the back side. Each size of nut can be installed into a large panel range. The steel nuts are hardened and designed to go into sheet less than 80 Rockwell B. The stainless version is designed to go into less than 70 Rockwell B. They are designed to be installed into drilled or punched holes and must always be installed using a squeeze action press.

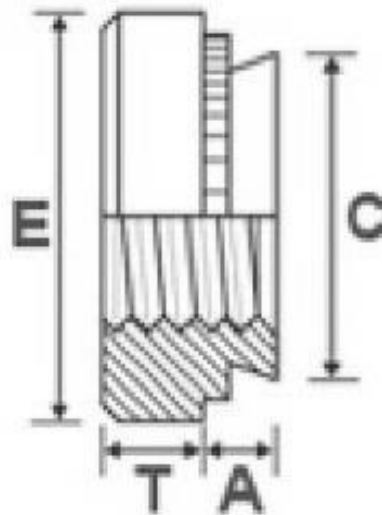

Thread	A	Shank	C	E	T	Hole size	Sheet
M2	0.76	0	4.20	6.30	1.50	4.25	0.80
M2	0.97	1	4.20	6.30	1.50	4.25	1.00
M2	1.37	2	4.20	6.30	1.50	4.25	1.40
M2.5	0.76	0	4.20	6.30	1.50	4.25	0.80
M2.5	0.97	1	4.20	6.30	1.50	4.25	1.00
M2.5	1.37	2	4.20	6.30	1.50	4.25	1.40
M3	0.76	0	4.20	6.30	1.50	4.25	0.80
M3	0.97	1	4.20	6.30	1.50	4.25	1.00
M3	1.37	2	4.20	6.30	1.50	4.25	1.40
M3	0.76	0	4.75	7.10	1.75	4.75	0.80

Thread	A	Shank	C	E	T	Hole size	Sheet
M3	0.97	1	4.75	7.10	1.75	4.75	1.00
M3	1.37	2	4.75	7.10	1.75	4.75	1.40
M4	0.76	0	5.40	7.90	2.00	5.40	0.80
M4	0.97	1	5.40	7.90	2.00	5.40	1.00
M4	1.37	2	5.40	7.90	2.00	5.40	1.40
M4	0.76	0	5.40	7.90	2.30	5.40	0.80
M4	0.97	1	5.40	7.90	2.30	5.40	1.00
M4	1.37	2	5.40	7.90	2.30	5.40	1.40
M5	0.76	0	6.40	8.70	2.00	6.40	0.80
M5	0.97	1	6.40	8.70	2.00	6.40	1.00
M5	1.37	2	6.40	8.70	2.00	6.40	1.40
M5	0.76	0	6.40	8.70	2.30	6.40	0.80
M5	0.97	1	6.40	8.70	2.30	6.40	1.00
M5	1.37	2	6.40	8.70	2.30	6.40	1.40
M6	1.37	1	8.75	11.05	4.10	8.75	1.40
M6	2.21	2	8.75	11.05	4.10	8.75	2.30
M8	1.37	1	10.50	12.65	5.50	10.50	1.40
M8	2.21	2	10.50	12.65	5.50	10.50	2.30
M10	2.21	1	14.00	17.30	7.50	14.00	2.30
M10	3.05	2	14.00	17.30	7.50	14.00	3.10

All dimension's in mm