

LARGE FLAT WASHER DIN9021

Large outside diameter flat washer to DIN9021.

Available in steel, steel zinc plated and Stainless Steel A2 & A4.

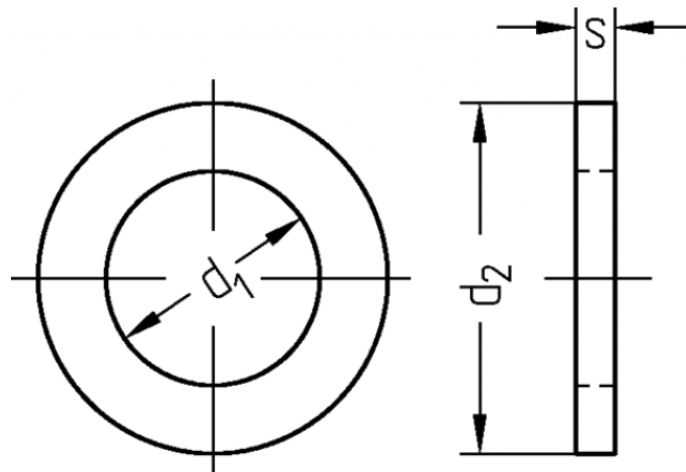

Dia. Nom.	d1	d2	s
M2	2.2	7.00	0.80
M2.5	2.7	8.00	0.80
M3	3.2	9.00	0.80
M3.5	3.7	11.00	0.80
M4	4.3	12.00	1.00
M5	5.3	15.00	1.20
M6	6.4	18.00	1.60
M8	8.4	24.00	2.00
M10	10.5	30.00	2.50
M12	13.0	37.00	3.00
M14	15.0	44.00	3.00
M16	17.0	50.00	3.00
M18	20.0	56.00	4.00
M20	22.0	60.00	4.00
M24	26.0	72.00	5.00
M30	33.0	92.00	6.00
M36	39.0	110.00	8.00

All dimension's in mm