

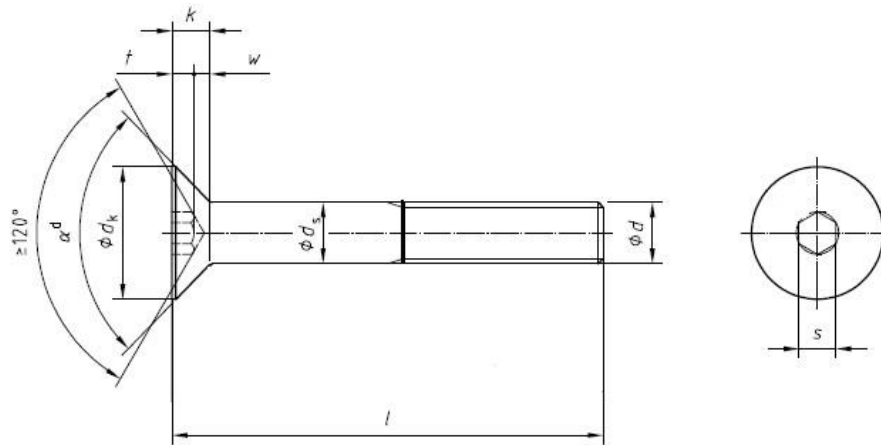

Flat Head Socket Cap Screws, Metric, Class 12.9, Black Oxide, Manufactured in the USA



| Nominal Size | Thread Pitch | ds | | dk | | k | s | | | t | w |
|--------------|--------------|---------------|-------|---------------|--------|-------------|---------------------|--------|--------|----------------|-------------|
| | | Body Diameter | | Head Diameter | | Head Height | Hexagon Socket Size | | | Key Engagement | Socket Wall |
| | | | | Theoretical | Actual | | | | | | |
| | | Max. | Min. | Max. | Min. | Max. | Nom. | Max. | Min. | Min. | Min. |
| M3 | 0.5 | 3.00 | 2.86 | 6.72 | 5.54 | 1.86 | 2.0 | 2.045 | 2.02 | 1.1 | 0.25 |
| M4 | 0.7 | 4.00 | 3.82 | 8.96 | 7.53 | 2.48 | 2.5 | 2.560 | 2.52 | 1.5 | 0.45 |
| M5 | 0.8 | 5.00 | 4.82 | 11.20 | 9.43 | 3.10 | 3.0 | 3.071 | 3.02 | 1.9 | 0.66 |
| M6 | 1.0 | 6.00 | 5.82 | 13.44 | 11.34 | 3.72 | 4.0 | 4.084 | 4.020 | 2.2 | 0.70 |
| M8 | 1.25 | 8.00 | 7.78 | 17.92 | 15.24 | 4.96 | 5.0 | 5.084 | 5.02 | 3.0 | 1.16 |
| M10 | 1.50 | 10.00 | 9.78 | 22.40 | 19.22 | 6.20 | 6.0 | 6.095 | 6.020 | 3.6 | 1.62 |
| M12 | 1.75 | 12.00 | 11.73 | 26.88 | 23.12 | 7.44 | 8.0 | 8.115 | 8.025 | 4.3 | 1.80 |
| M16 | 2.0 | 16.00 | 15.73 | 33.60 | 29.01 | 8.80 | 10.0 | 10.115 | 10.025 | 4.8 | 2.20 |

Specification Requirements:

- Dimensions: ISO 10642 (1997)
- Threads: 4g6g
- Material & Mechanical Properties: ISO 898-1 Grade 12.9 per ISO 10642
- Finish: Thermal or Chemical Black Oxide