

HEXAGON HEAD SETSCREW DIN933

Hexagon headed fully threaded setscrew to DIN933. Available in grades 8.8, 10.9, 12.9 in self colour and zinc plated other finishes available to order.

Also available in Brass, nylon66, aluminium and Stainless Steel grade A2 & A4

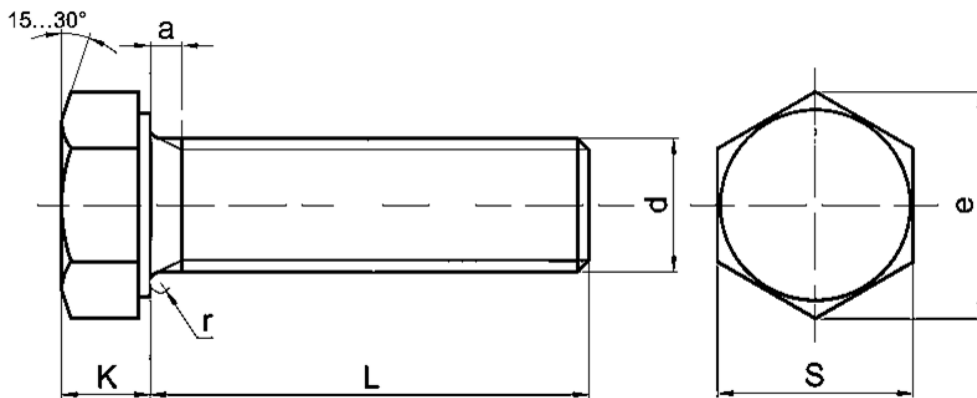

"d" Nom.	"s"	"e"	"k" Nom.	"a" Max.
M3	5.50	6.01	2.00	1.50
M4	7.00	7.66	2.80	2.10
M5	8.00	8.79	3.50	2.40
M6	10.00	11.05	4.00	3.00
M7	11.00	12.12	4.80	3.00
M8	13.00	14.38	5.30	3.75
M10	17.00	18.90	6.40	4.50
M12	19.00	21.10	7.50	5.25
M14	22.00	24.49	8.80	6.00
M16	24.00	26.75	10.00	6.00
M18	27.00	30.14	11.50	7.50
M20	30.00	33.53	12.50	7.50
M22	32.00	35.72	14.00	7.50
M24	36.00	39.98	15.00	9.00
M27	41.00	45.20	17.00	9.00
M30	46.00	50.85	18.70	10.50
M33	50.00	55.37	21.00	10.50
M36	55.00	60.79	22.50	12.00
M39	60.00	66.44	25.00	12.00
M42	65.00	71.30	26.00	13.50
M45	70.00	76.95	28.00	13.50
M48	75.00	82.60	30.00	15.00

All dimensions in mm