

## CSK HEAD CRS MACHINE SCREW DIN965

Countersunk or flat head CRS machine screw to DIN965.  
Available fully threaded in mild steel, mild steel zinc plated and Stainless Steel grade A2 & A4

Csk lengths are measured including the head.

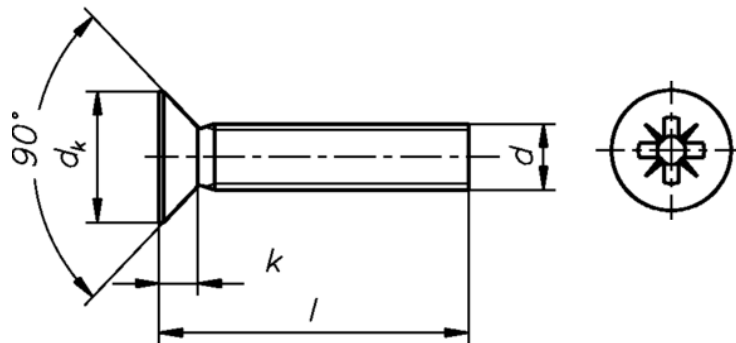

d Nom.	dk	k Max.	Driver Bit Size
M1	1.90	0.60	-
M1.2	2.30	0.72	-
M1.4	2.60	0.84	-
M1.6	3.00	0.96	0
M1.8	3.40	1.08	0
M2	3.80	1.20	1
M2.5	4.70	1.50	1
M3	5.60	1.65	1
M4	7.50	2.20	2
M5	9.20	2.50	2
M6	11.00	3.00	3
M8	14.50	4.00	4
M10	18.00	5.00	4
M12	22.00	6.00	4
M16	29.00	8.00	4

All dimension's in mm